

Monash University Caulfield Campus Decanting



Photograph provided by K20

Client

Monash University

Architect & Interior

Six Degrees
K20 Architecture
Dr Mark Richardson &
Dr Matthew Bird

Builder

Shape / Harris HMC
SimBuilt / Neo Construct

Budget

\$14 mil

Year

2013 / 2014 / 2015 / 2016

Project:

Monash University Caulfield Campus is 5.3 hectares in size and consists of 14 buildings and over 108,000 square meters gross floor area of building space area.

To accommodate the Caulfield Campus master planning and major redevelopment of Building A, various buildings across the campus had been decanted and re-fitted as a part of a work programme starting in 2013.

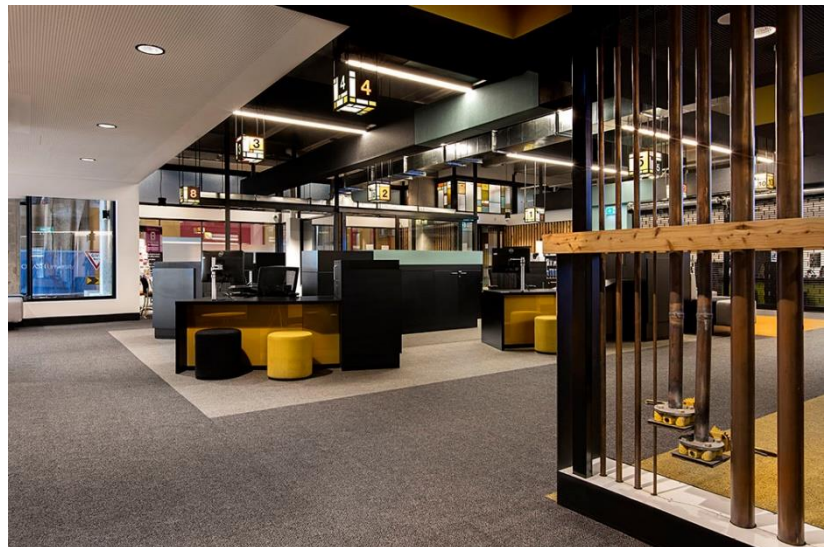

Photograph provided by Six Degree

BE Contribution:

BE was engaged to provide full building services consultation and design to the decanting and new fit out works including redevelopment of Building B & Building C street front level, new fit out for Monash Connect, e-solutions, student study spaces, cafe, student lounges, worship space, maintenance workshops, administration areas and the award winning Hydronaut Security Kiosk.

The project started from 2013 and completed early 2016. BE worked collaboratively with various stakeholders in Monash University, architects, builders, sub-contractors and suppliers to achieve high level of client satisfaction and meet all the goals set by Monash University.

Referees

Alexis Kouts
Senior Project Manager
Monash University
Tel 03 9905 6896

Peter Malatt (former AIA Victorian Chapter President)
Director
Six Degrees
Tel 03 9635 6000